



UConn

Student Recreation Center Green Features

THE Sustainable
SITES
Initiative



UConn's Student Recreation Center is the first UConn building to target both LEED Gold and SITES certification. These two certifications distinguish sustainable landscapes & buildings that are healthy, cost-effective, and efficient. Look for these sustainable design & construction features around the building!

CONSTRUCTION & MATERIALS

1. **Forest Stewardship Council (FSC)** certified wood accounts for over 50% of the new wood used in construction
2. **Diverted** 77% of construction waste from landfills and incineration plants

LANDSCAPING

3. **Native and drought tolerant landscaping** requires no permanent irrigation, saving water
4. **Permeable paving** in the parking lot reduces storm water runoff
5. **Canopy trees** & seating options encourage a pedestrian friendly environment



ENERGY & WATER EFFICIENCY

6. Overall anticipated annual **energy savings of 26%** and energy cost savings of 46% compared to the baseline building performance according to ASHRAE Standard 90.1-2007 Appendix G
7. **LED lighting** throughout the building reduces interior lighting energy by 35%
8. **Daylight sensors** near the windows reduce artificial lighting when sunlight meets the needs for the area
9. **Insulated walls and roof** contribute to an anticipated 60% reduction in annual heating energy; **low-SHGC glazing, better airside economizer control, heat recovery, and ceiling fans** contribute to an anticipated 31% reduction in annual cooling energy.
10. **Low flow faucets, showerheads, & toilets** contribute to water savings of over 40%



INDOOR AIR QUALITY

11. **CO₂ sensors** maintain indoor air quality by increasing ventilation when building occupancy increases
12. **Low-emitting paints & green cleaning** used throughout the building provide for healthier indoor air and reduced exposure to harmful chemicals

EXERCISE EQUIPMENT

13. **Bikes** in the cycling classes turn off when users are not pedaling, saving energy
14. **30% of equipment** was repurposed from the old Rec center, reducing waste

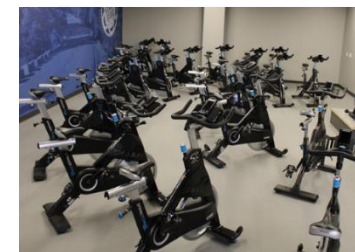

For questions, contact us:

Office of Sustainability

sustainability@uconn.edu

(860) 486-5446

FIRST FLOOR

SCHOOL OF BUSINESS QUAD 5

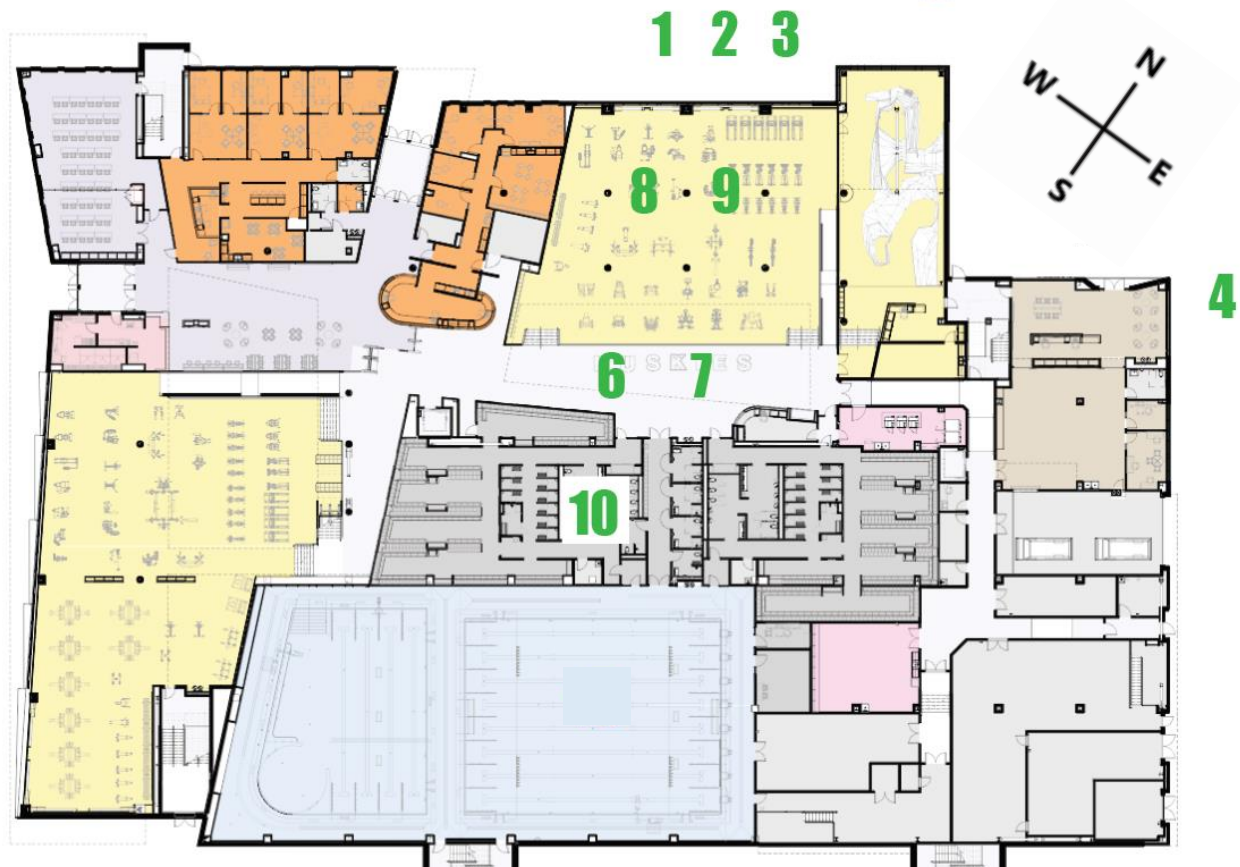

SECOND FLOOR

